

1

2

3

4

A

B

C

D

A

B

C

D

REV. 版本	ECN NO. 变更说明	DATE 日期
01-09	ADD PART NUMBER	09/01/16
10	更改尺寸标注	09/06/22
11-12	ADD PART NUMBER	09/10/05
13-15	ADD PART NUMBER	09/12/28

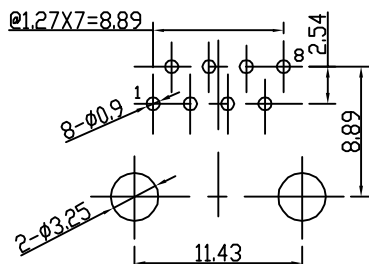
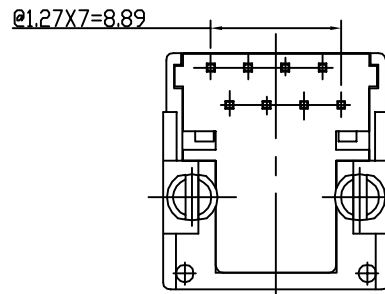
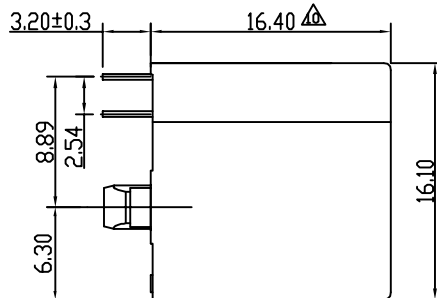
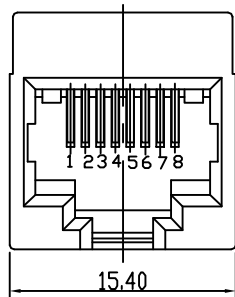

PC BOARD LAYOUT
THICKNESS=1.6MM

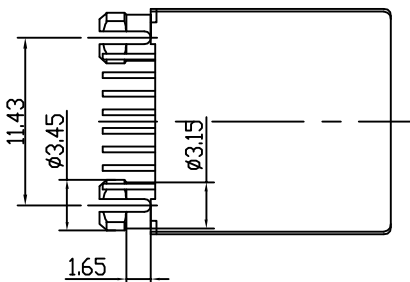

NOTES:

ELECTRICAL:

- 1. VOLTAGE RATING : 125 VAC RMS.
- 2. CURRENT RATING : 1.5 AMP.
- 3. CONTACT RESISTANCE : 45 MILLIOHMS MAX.
- 4. INSULATION RESISTANCE : 1000 MEGOHMS MIN @ 500 VDC.
- 5. DIELECTRIC STRENGTH : 1000 VAC RMS 60Hz, 1MIN.

MECHANICAL:

- 1. HOUSING & INSERT MATERIAL : PBT/PA66/PA46 UL94V-0.
- 2. CONTACT MATERIAL : PHOSPHOR BRONZE T=0.35mm.
- 3. PLATING : 1: CONTACT AREA- SELECTIVE GOLD PLATING.
2: TAILS PLATING TIN OVER NICKEL.
- 4. MATING/UNMATING FORCE : 22N/2.27kg Max..
- 5. RETENTION STRENGTH : 57.83N Min. .
- 6. OPERATING LIFE : 750 CYCLES MIN.

机构特性:

- 1. 塑壳材 质:PBT/PA66/PA46,UL94V-0;
- 2. 扁针材质: 磷青铜, 厚度0.35mm;
- 3. 扁针电镀: 接触区镀金(见料号表格), 镍底, 剥头电镀雾锡;
- 4. 插入/拔出力: 22N/2.27kg Max.
- 5. 配合强度: 57.83N Min.
- 6. 可靠性: 最少750次插拔

电气特性:

- 1. 额定电压: 125 VAC RMS
- 2. 额定电流: 1.5 AMP
- 3. 接触电阻: 45mΩ MAX.
- 4. 绝缘电阻: 1000MΩMIN, @500 VDC
- 5. 耐压强度: 1000 VAC RMS 60Hz, 1分钟

环境特性:

- 1. 储存温度: -10°C~+40°C 相对湿度<80%.
- 2. 工作温度: -40°C~+85°C

ENVIRONMENTAL:

- 1. STORAGE : -10°C~+40°C RELATIVE HUMIDITY<80%
 - 2. OPERATION : -40°C~+85°C
- MATES WITH MODULAR PLUG CONFORMING TO FCC PART 68, SUBPART F.

5224 8P 插座

RoHS Compliant

Coorle 库乐科技

TOLERANCES 公差

- 00~15 ± 0.15
- 15~30 ± 0.20
- 30~ ± 0.25
- ANGLES ±1°

Material: 材质
SEE_NOTE

Finish: 电镀
SEE_NOTE

SHEET 1 OF 1
第 1 页 共 1 页

Designed: 设计

Checked: 审核

Approved: 核准

NAME: 名称

DWG NO: 图号

PART NO: 料号

RJ45 5224 8P JACK

REV. 版本

15



A4
SIZE

SCALE 比例
1:1

UNIT 单位
mm

CUSTOMER: 客户
MODEL NO: 料号

1

2

3

4